

CLEAR SPAN BUILDINGS NON CERTIFIED

STATES: AR, OK, MO, NE, IL, IN, IA, KS, WI, WY, MI, CO, SD



Vertical Roof



UNIT SHOWN IS A 32X40X12
 -BOTH SIDES CLOSED HALF WAY DOWN
 -1-CLOSED END

WXL 32'-40'W VERTICAL ROOF STYLE STD 8FT TALL

32x20X8	32x25X8	32x30X8	32x35X8	32x40X8	32x45X8	32x50X8
\$12,264	\$13,421	\$14,832	\$17,103	\$19,253	\$21,404	\$23,636
34x20X8	34x25X8	34x30X8	34x35X8	34x40X8	34x45X8	34x50X8
\$13,152	\$14,295	\$15,639	\$17,991	\$20,328	\$22,695	\$24,980
36x20X8	36x25X8	36x30X8	36x35X8	36x40X8	36x45X8	36x50X8
\$13,959	\$15,101	\$16,512	\$18,984	\$21,404	\$23,904	\$26,391
38x20X8	38x25X8	38x30X8	38x35X8	38x40X8	38x45X8	38x50X8
\$16,364	\$17,520	\$18,932	\$21,753	\$24,629	\$27,465	\$30,356
40x20X8	40x25X8	40x30X8	40x35X8	40x40X8	40x45X8	40x50X8
\$18,447	\$19,671	\$21,015	\$24,173	\$27,399	\$30,624	\$33,768

REFLECTIVE INSULATION ADD ON ROOF ONLY:
 Add 2' to width and multiply by length.
 EX. 32' wide x 20' long (34x20= 680 sf x 2.50 = \$ 1,700)

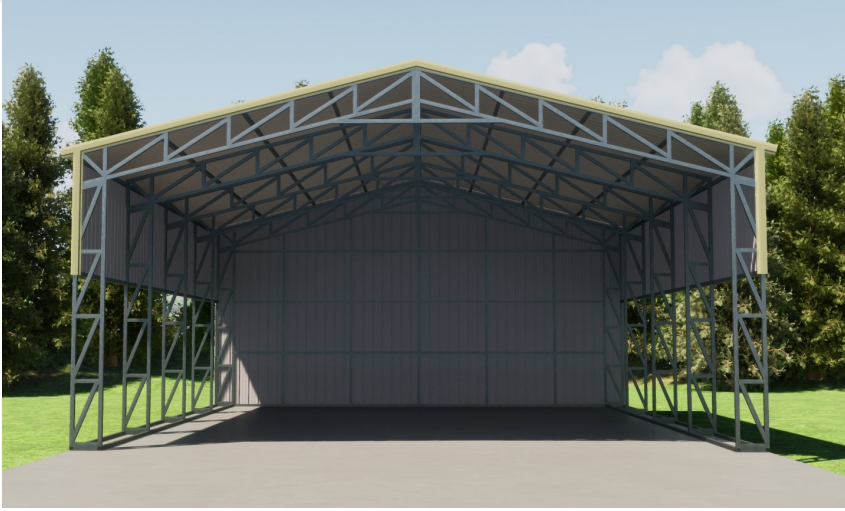

Standard Features Include:
 12 Gauge frame, 8ft Std legs, 29 Gauge roofing, maximum rafter 10' on center or less depending on the length, zig zag truss design, fully open. Customer must supply lull lift for all building sizes.
(ALL SIZES MUST BE INSTALLED ON A CONCRETE SURFACE ONLY)

- Free Installation On Your Level Lot
- Engineer Plans Available Call 877-494-2997
- Note: Frame Lengths Are 20', 25', 30' Etc. Vertical Roofs Have No Overhang Front Or Back.
- Financing Available / Rent To Own Available
- Rebar Anchors Included /Concrete Anchors Included



2023 V2

*30 Day Workmanship warranty on all Buildings, effective day of Installation.
 *20 Year limited warranty on 12 Gauge framing materials assuming regular care and maintenance given to building.

We strongly recommend you to purchase vertical roofs on buildings 31ft or longer to prevent leaks.

Leg Height	20' Long	25' Long	30' Long	35' Long	40' Long	45' Long	50' Long
8' Tall Standard							
9 Ft Tall	\$945	\$1,035	\$1,125	\$1,215	\$1,317	\$1,407	\$1,497
10 Ft Tall	\$1,215	\$1,362	\$1,508	\$1,655	\$1,800	\$1,947	\$2,093
11 Ft Tall	\$1,520	\$1,710	\$1,902	\$2,093	\$2,285	\$2,475	\$2,667
12 Ft Tall	\$1,823	\$2,060	\$2,295	\$2,532	\$2,768	\$3,005	\$3,240
13 Ft Tall	\$2,127	\$2,408	\$2,690	\$2,970	\$3,252	\$3,533	\$3,815
14 Ft Tall	\$2,622	\$3,015	\$3,140	\$3,410	\$3,735	\$4,073	\$4,410
15 Ft Tall	\$2,892	\$3,342	\$3,455	\$3,848	\$4,220	\$4,613	\$5,007
16 Ft Tall	\$3,162	\$3,668	\$3,780	\$4,287	\$4,703	\$5,153	\$5,603



CLOSE BOTH SIDES (STD VERTICAL SIDING)								CLOSE ONE END (STD VERTICAL SIDING)				
Leg Height	20' Long	25' Long	30' Long	35' Long	40' Long	45' Long	50' Long	32' Wide	34' Wide	36' Wide	38' Wide	40' Wide
8 Ft Tall	\$1,580	\$1,934	\$2,309	\$2,703	\$3,119	\$3,351	\$3,707	\$3,657	\$3,938	\$4,220	\$4,500	\$4,782
9 Ft Tall	\$1,712	\$2,106	\$2,522	\$2,957	\$3,413	\$3,656	\$4,050	\$3,929	\$4,209	\$4,491	\$4,772	\$5,054
10 Ft Tall	\$1,853	\$2,289	\$2,744	\$3,221	\$3,716	\$3,980	\$4,415	\$4,200	\$4,482	\$4,763	\$5,045	\$5,325
11 Ft Tall	\$2,198	\$2,724	\$3,270	\$3,837	\$4,425	\$4,760	\$5,286	\$4,472	\$4,754	\$5,034	\$5,316	\$5,597
12 Ft Tall	\$2,349	\$2,916	\$3,504	\$4,112	\$4,739	\$5,103	\$5,866	\$4,745	\$5,025	\$5,307	\$5,588	\$5,870
13 Ft Tall	\$2,501	\$3,108	\$3,737	\$4,385	\$5,052	\$5,448	\$6,056	\$5,016	\$5,297	\$5,579	\$5,859	\$6,141
14 Ft Tall	\$2,663	\$3,311	\$3,980	\$4,668	\$5,570	\$5,813	\$6,461	\$5,288	\$5,570	\$5,766	\$6,132	\$6,413
15 Ft Tall	\$3,027	\$3,767	\$4,526	\$5,306	\$6,105	\$6,632	\$7,371	\$5,559	\$5,841	\$6,038	\$6,404	\$6,684
16 Ft Tall	\$3,189	\$3,929	\$4,688	\$5,468	\$6,267	\$6,794	\$7,533	\$5,832	\$6,113	\$6,309	\$6,675	\$6,957

REFLECTIVE INSULATION (BOTH SIDES) ADD ON:

Multiply leg height by length by 2.

EX. 20' long x 8' tall $8 \times 20 = 160 \text{ sf} \times 2 = 320 \text{ sf} \times 2.50 = \800.00 both sides

REFLECTIVE INSULATION (PER END) ADD ON:

Add 3' to leg height multiply by width

EX. 32' wide x 8' tall $11 \times 32 = 352 \text{ sf} \times 2.50 = \880.00 per end

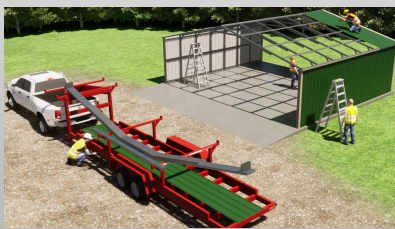

Want to be a carport installer? call us 877-494-2997 for more info!

Add \$100.00 Trip Fee on any purchase less than \$500.00

CONCRETE DIMENSIONS

In reference to frame size Ex. 32' Wx20' L building frame size. Make pad 32'8" Wx20'8" L. the extra 4" all around make it slope away from the building edge to run off water.

Connection fees valid only if you are purchasing 2 buildings at the same time (not on existing buildings)

Connecting end to end. \$200.00
Connecting side to side. \$250.00

EXTRA FRAME BOW		WINDOWS white with grids	GARAGE DOORS	*GABLE END (VERTICAL)
32'-36' WIDE \$1,152 EA. 38'-40' WIDE \$1,296 EA.		24"X36" \$190.00 EA.	6'WX6'H \$704.00 EA.	32'-36' WIDE \$720 EA. 38'-40' WIDE \$864 EA.
ADD \$30.00 FOR EACH ADDITIONAL HEIGHT.			8'WX7'H \$848.00 EA.	*CARPORT PEAK ENCLOSED
MOBILE HOME ANCHORS	ASPHALT ANCHORS	*36' LONG \$216.00 EA. *41' LONG \$259.00 EA. *NOT A CONTINUOUS PANEL.	9'WX7'H \$920.00 EA.	**EXTENDED GABLE(VERTICAL)
3/4"X30" \$30.00 EA.	3/4"X30" \$30.00 EA.		10'WX8'H \$992.00 EA.	32'-36' WIDE \$1,152.00 EA. 38'-40' WIDE \$1,296.00 EA.
WALK IN DOOR left outswing	EXTRA PANELS 36" wide		10'WX10'H \$1,064.00 EA.	**GABLE PLUS 3' PANEL
36"X80" \$515.00 EA.	21' LONG \$130.00 EA.	*36' LONG \$216.00 EA.	12'WX12'H \$2,304.00 EA.	
ADD \$50.00 SIDE FEE (IF FRAME HEADER BAR IS NEEDED ADD \$100)	26' LONG \$158.00 EA.	*41' LONG \$259.00 EA.	ADD \$100.00 SIDE DOOR FEE (PER EACH DOOR) <u>BUILDING MUST BE 1' TALLER TO INSTALL DOOR ON SIDE.</u>	
<u>BUILDING MUST BE A MIN OF 7FT TALL TO INSTALL DOOR ON SIDE.</u>	31' LONG \$187.00 EA.			
EXTRA L TRIM	EXTRA J TRIM	45° TRIM KIT		
\$1.25 (PER FT)	\$1.12 (PER FT)	\$99.00 EA. MUST CLOSE END OR SIDE FIRST.		



FRAME OUTS	WINDOW <u>\$80.00 EACH</u>	DOOR FRAME OUTS	6'W-12'W ON END <u>\$200.00 EACH</u> 13'W-16'W ON END <u>\$400.00 EACH</u>	16FT WIDE MAX ON END AND SIDE DOOR OPENINGS	ON ENDS: MUST CLOSE FIRST FOR FRAME OUTS, IF NO PANELS WANTED ON END (FRAME END ONLY) <u>DISCOUNT 20% FROM CLOSED END PRICE.</u>
	WALK DOOR <u>\$90.00 EACH</u>		6'W-12'W ON SIDE <u>\$600.00 EACH</u> 13'W-16'W ON SIDE <u>\$900.00 EACH</u>		

2023 V2



Zig Zag leg system



Reflective Insulation

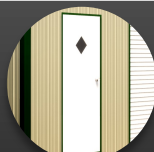

Walk in door



Roll up door



Window



45° Trim Kits

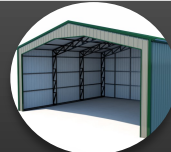

Gable end